

Always a
cut ahead!



All-purpose cutting device SPEWE 1900ML-30



SPEWE. 

SPEWE 1900ML-30

Convincing details

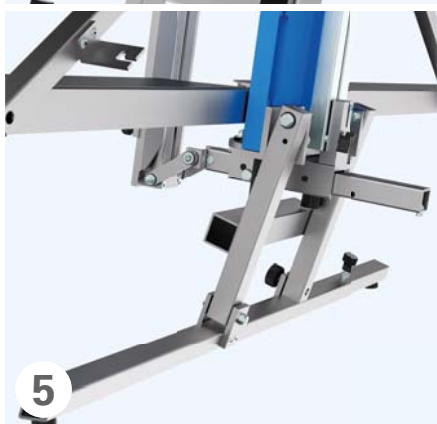
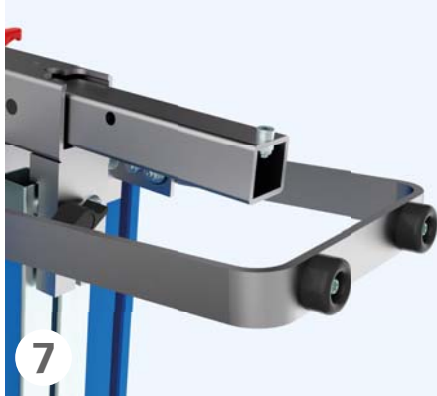

Types of cuts

straight

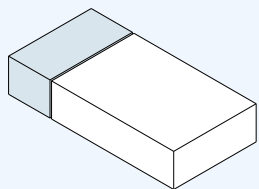

mitre

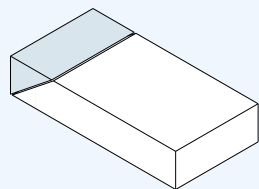

bevel

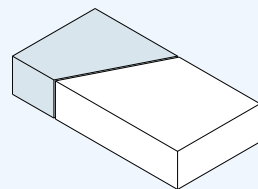

bevel with mitre

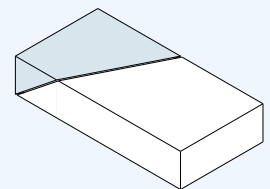

All-purpose cutting device

Installation positions



- 1** Preset values set to insulation thickness with locking mechanism (9–13 cm / 13–17 cm / 16–20 cm / 20–24 cm / 23–27 cm / 27–31 cm)
- 2** Short-stroke parallelogram for user-friendly clamping of cutting material
- 3** Cutting tool guided on both sides. The clearance of the rear guide rails can be precisely adapted to the width of the cutting tool
- 4** Swivel-mounted cutting guide from -5° to $+45^{\circ}$ with latching at 90°
- 5** Integrated double-hinged foot with extra long tread for improved equipment even with heavy plates
- 6** Double-sided large swivel-mounted plate bearings for precise and individual bevel cuts
- 7** Wall support enables working on scaffolding without a free-standing support
- 8** Optional cutting guides with spring-loaded pawl to attach selected brand sawing machines and reciprocating saws
- 9** For use with optional sawing machine (DeWalt or Bosch) or optional sabre saw (Bosch Battery, Milwaukee Battery)
- 10** Stand-alone unit with optional roller and plate stands as support and for guiding heavy insulation panels
- 11** Stand-alone unit with optional roller and plate stands for efficient processing of rolls of insulation felt



Accessories for SPEWE 1900ML-30

Included with the equipment

Telescopic free-standing support

Open-end wrench M5/M6

Optionally available

Cut reduction for plate thicknesses of 10 to 100 mm

Saw guide for cuts with circular handsaws

Cutting guides for selected sabre saws

Roller and plate stand



The product

All-purpose cutting device SPEWE 1900ML-30 for electrical cuts. Suitable for stone and glass-wool plates, cellular glass, fibreboard plates, ecological insulation material, cork, polyisocyanurate (PIR), polyurethane (PUR), sandwich panels etc. Quick start-up is guaranteed as all parts are mounted on the device. Can also be used on the scaffold thanks to low construction height (only 185 cm). Variety of extensions.

Technical Data

- Cutting depth at 90°: 90 - 300 mm
- Cutting depth at 45°: 90 - 180 mm
- Cutting length: 1270 mm
- Weight: 26.0 kg

Delivery information

SPEWE 1900ML-30 cutting device, with telescopic free-standing support, swivel-mounted guide arms on the side, cutting guides, open-end wrench M5/M6

Spewe AG

Hauptstrasse 332
Gewerbegebiet Mösl
CH-5326 Schwaderloch

Phone: +41 56 203 03 30
Fax: +41 56 203 03 31
Website: www.spewe.ch

